

FEATURES

This innovative PT's with detents family has been specifically developed to allow the integration of otherwise large and expensive external mechanisms into the body of the majority of the 10 & 15 mm. PT/PTC potentiometer series.

This detent design not only adds a "click" sensation of position, but also offers enormous savings in both cost and space for any given application.

MAIN SPECIFICATIONS

All the PT'S with detents series maintain the original specification & features of the chosen potentiometer.

TYPICAL APPLICATIONS

As previously highlighted, this family is indispensable wherever both cost and space saving reductions are important, or where a series of fixed positions along the potentiometer travel are required, eg:

- Replacement for:
 - Existing customer detent mechanisms.
 - Multi-pole switches.
 - 3 or 4-bit absolute encoders (connecting PT to microprocessor analogue input).
- Analogue signal presets.
- Temperature control settings.
- Relay Timers.

PT's with detents also lend themselves perfectly to Industrial and Domestic Power Tool applications where the detents prevent accidental movement of the potentiometer under vibration.

HOW TO ORDER

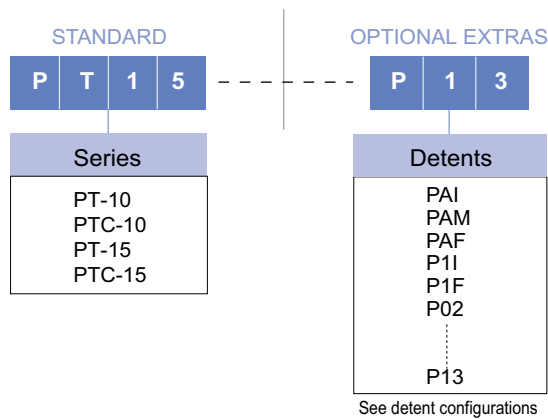

NOTES:

- (1) • Detents not available with:
- PT / PTC-10 V 05
 - PT / PTC-15 V 02 & V21
 - PT / PTC-15 V 12 & V22
 - PT / PTC-15 V 18
 - PT-15 V 24
- These cases are studied individually.

(2) • Standard mechanical life is 500 cycles.

- (3) • Long life versions are available under request and have the following characteristics at T^a:
- PT's with 1 to 3 detents: up to 10k cycles
 - PT's with 4 and more detents: up to 5k cycles

(4) • Detent torque can vary from 1.2 to 2.5 times the standard potentiometer torque

(5) • Please consult your nearest Piher supplier if unique non-overlapping values at each detent position or LOG/ALOG tapers are required.

(6) • Please note that if you want a high number of detents and a different value at each detent position (special taper), the Residual Resistance is $\leq 7.5\% R_n$

NOTE: The information contained here should be used for reference purposes only.

DETENT CONFIGURATIONS

 Relative detent positions along the total mechanical travel. Unless otherwise specified the detents are evenly spaced (using the end points as reference)

- Max. number of detents:
 • PT-10, PTC-10 10
 • PT-15, PTC-15 13

PT/PTC-10: A= 26°
 B= 27.5°
 PT/PTC-15: A= 32.625°
 B= 34.5°

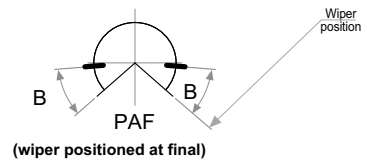
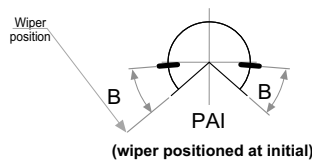
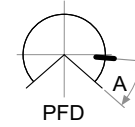
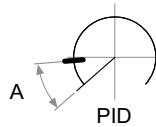
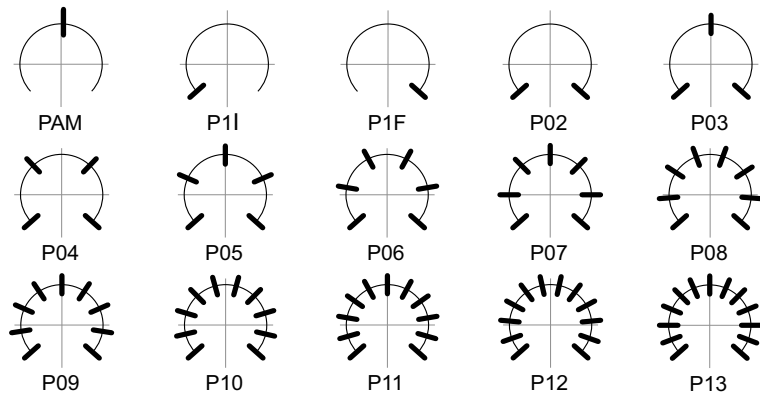

DETENT DETAILS

PT/PTC-10 P10 ...

PT/PTC-15 P13 ...

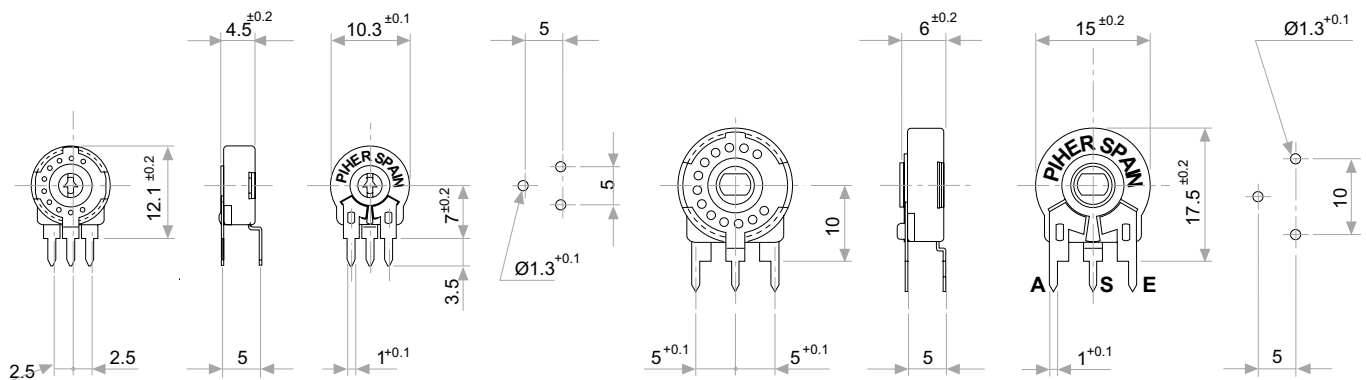

A = Initial S = Wiper E = Final

NOTE = Please note relative terminal positions when ordering non linear tapers. Special configurations to be studied upon request.