

CLIFF

Plastic Rotary Control Knobs

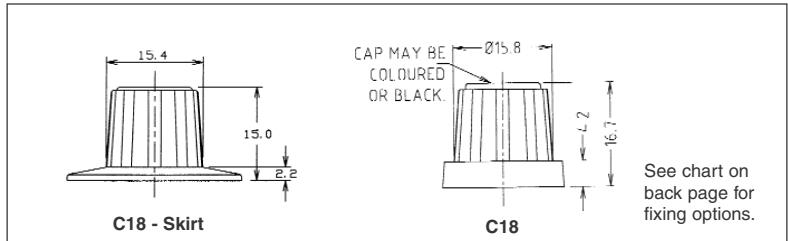

C18 and C18 skirt. Caps supplied pre-fitted and are available in seven standard colors. Skirt version can be supplied plain, printed 0 - 10 or with marker line.



See chart on back page for fixing options.



KVS silk touch finish. Available in two sizes, can be plain or with a marker dot. Push fit. Standard color is black.

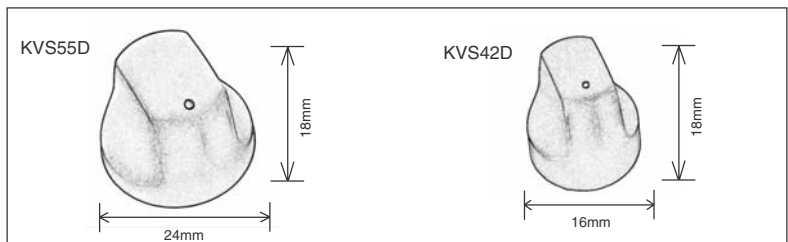

Ordering Information

When specifying the fixing options from the table below, indicate the shaft size and type required, i.e: Screw Fix (SF), Push-Fix (D), Splined (SPL) or Collet.

Shaft Size	3mm	4mm	4mm	4mm	6mm	6mm	6mm (USA)	6mm	6mm	1/4 inch	1/4 inch	1/4 inch	1/4 inch	Marker Dot & Line options
Knob Type														
K1				●	●				●	●	●	●	●	S (standard)
K2				●					●	●	●	●	●	S (standard)
K3, K4				●					●	●	●	●	●	Z
K5				●	●				●	●	●	●	●	Z
K6, K6/SKT				●					●	●	●	●	●	D SL N
K7				●	●				●	●	●	●	●	Z
K8				●					●	●	●	●	●	S (standard)
K9*	●		●	●	●	●	●	●	●	●	●	●	●	LDZ
K10*	●		●	●	●	●	●	●	●	●	●	●	●	LDZ
K11	●		●	●	●	●	●	●	●	●	●	●	●	LDZ
K12	●		●	●	●	●	●	●	●	●	●	●	●	LDZ
K17									⊘	⊘		●	●	Z (standard)
C18, C18/SKT					●	●	●			●				C18-Z (standard) C18-SKT SL N
KVS42D					●		●							Dot optional
KVS55D					●		●							Dot optional

Key: Collet Splined D Screw

● = Available as standard
⊘ = Enquire if required

L= Body Line
D=Cap Out
S=Skirt Dot

Z=Cap Line
SL=Skirt Line
N=Numbered

*For all black model only - version with integral cap is available. Not all push fix models have metal springs.

CLIFF

Plastic Rotary Control Knobs



K1



K2



K3



K4



K5



K6



K7



K8



K9



K10



K11



K12



K17



C18



C18 Skirt



KVS42D

The **CLIFF**® range of Rotary Control Knobs is designed to enhance the appearance and functionality of any equipment to which they are fitted. All models are molded from tough Nylon, ABS or Polypropylene and some models can be supplied in other standard colors or produced in custom colors to order, subject to a reasonable order quantity. Most knobs are available for various shaft and fixing options, and with printed marker lines, marker dots, numbers, arrows or legends when applicable. Other models are available with a soft touch rubberized finish. See separate Data Sheet - Two Color Molded Control Knobs.

Cliff Electronic Components, Inc.



K1 and K2.
Available with or without chrome, satin or colored disc tops. Marker dot on skirt. Standard body color black.

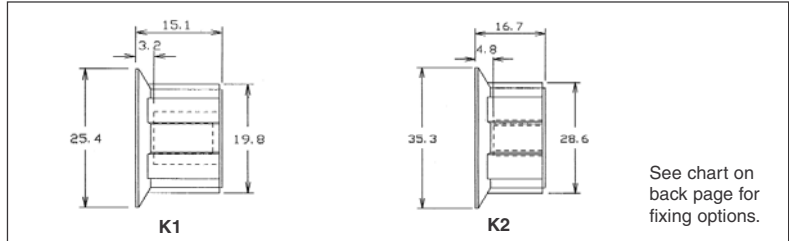

See chart on back page for fixing options.



K3 & K4 'Chicken Head'. Combination gloss and matt textured finish. Marker line also available. Standard color black.

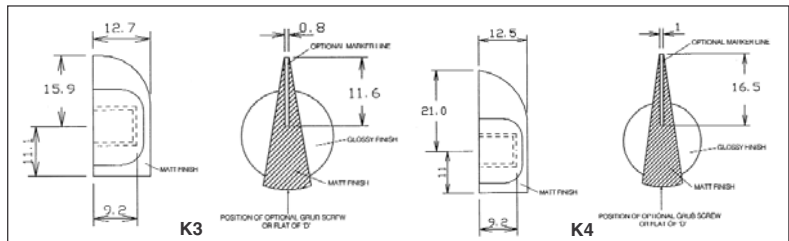

K5 with spun aluminium cap. Marker line or plain cap available. Standard body color black.

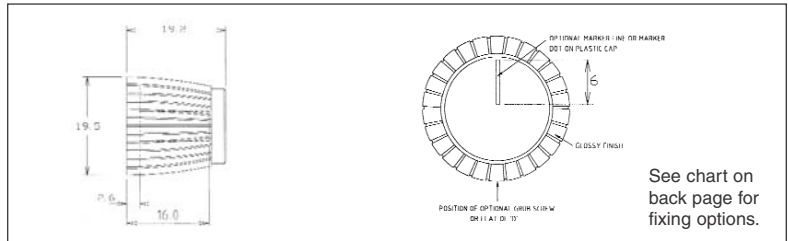

See chart on back page for fixing options.



K6 with spun aluminium cap. Marker dot or plain cap available. Standard body color black. Marker line or plain cap available. Standard body color black. Numbered (0-5-0 or (0-10) and plain clear skirts available.

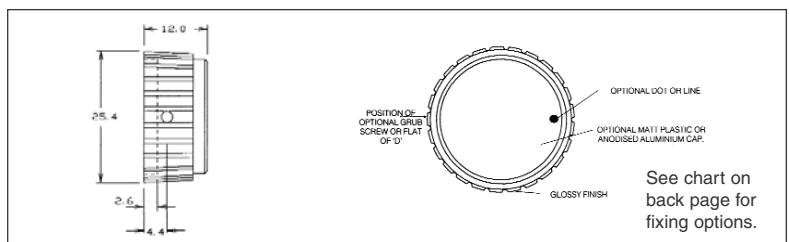

See chart on back page for fixing options.



K7 with spun aluminium cap. Marker line or plain cap available. Standard body color black.

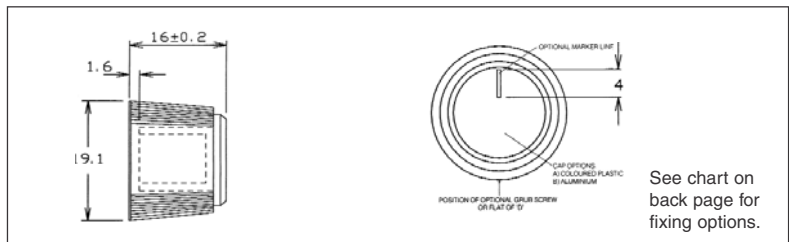

See chart on back page for fixing options.



K8 with spun aluminium cap. Marker dot on skirt. Standard body color black.

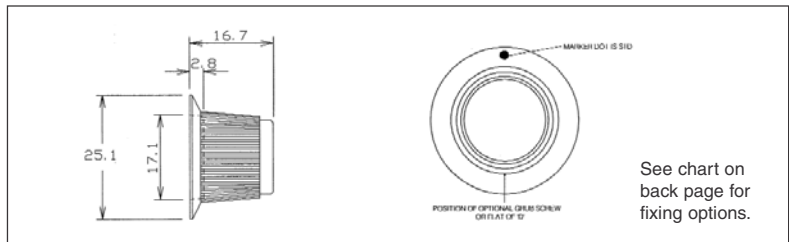

See chart on back page for fixing options.



K9 with push-in caps, available in 8 standard colors. Knob and cap can be plain or with a marker line or dot. Standard body color is black.

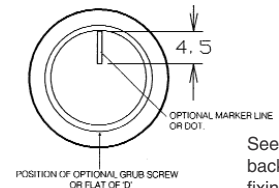
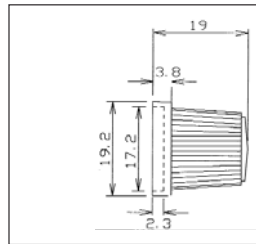

See chart on back page for fixing options.



K10 with push-in caps, available in 8 standard colors. Knob and cap can be plain or with a marker line or dot. Standard body color is black.

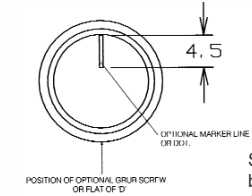
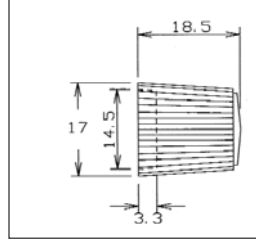

See chart on back page for fixing options.



K11 with push-in caps, available in 8 standard colors. Knob and cap can be plain or with a marker line or dot. Standard body color is black.

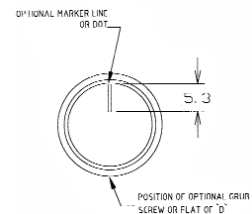
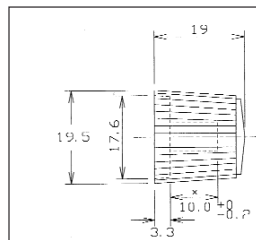

See chart on back page for fixing options.



K12 with push-in caps, available in 8 standard colors. Knob and cap can be plain or with a marker line or dot. Standard body color is black.

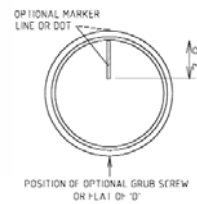
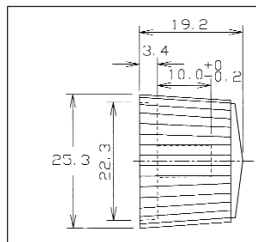

See chart on back page for fixing options.



K13 engineering knobs. Incorporates threads or threaded studs. Knobs can be supplied unassembled if required. Standard knob color is black.

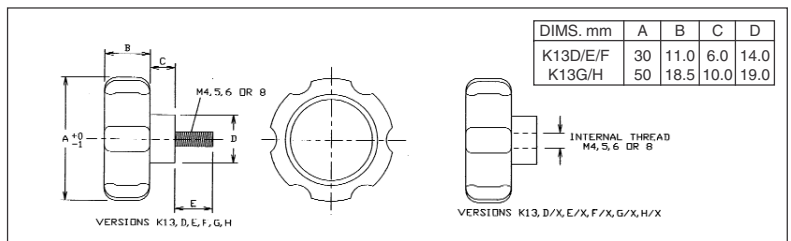

K17 with fine serrated edge and matt finish. Standard colors black and white, plain or with marker line. Suitable for medical and cosmetic equipment.

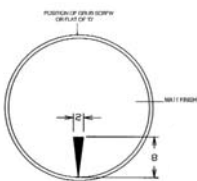
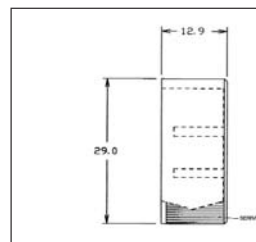

See chart on back page for fixing options.