

ISS	AMEND	DATE
1	1st DRAWN	18/1/99

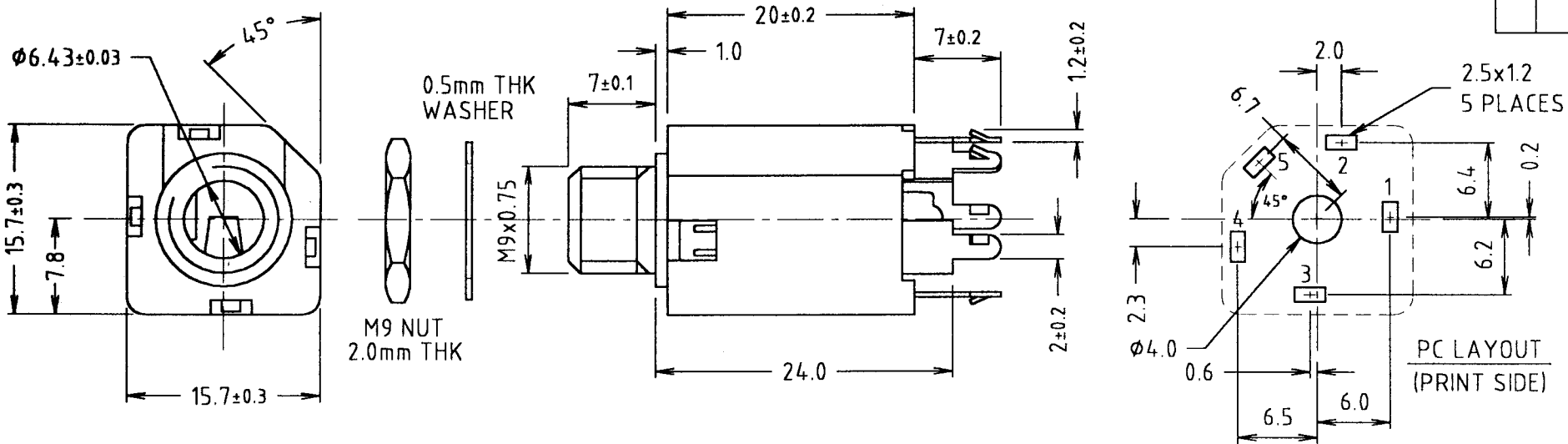

MODEL	S1V/S/SBB	S1V/S/SSB	S1V/S/SBS	S1V/S/SSS	S1V/S/SNB	S1V/S/SNS
P/No.	FM 6700	FM 6701	FM 6702	FM 6703	FM 6704	FM 6705
SCHEMATIC						

Tolerance
 NO DEC. PLACE ± 0.50
 1 DEC. PLACE ± 0.20
 2 DEC. PLACE ± 0.10
 DIA. HOLES ± 0.10
 ANGLES ± 1/2°
 UNLESS OTHERWISE STATED

DIMENSIONS IN MILLIMETERS UNLESS OTHERWISE STATED. WORK TO DIMENSIONS. DO NOT SCALE DRAWING. 3rd ANGLE PROJECTION. REMOVE BURRS. IF IN DOUBT ASK.

**WHERE USED F.R.
 SCALE N.T.S.**

Cliff Electronic Components, Inc.
 4876 East Second Street, Benicia, CA 94510 USA
 Tel: (707) 746 8090 Fax: (707) 746 8092

MATERIAL COMPOSITE
FINISH CLEAN
DRAWN C.A.M.J. APPD. RWT

TITLE METAL BUSH VERTICAL JACK MODEL S1V/S
DRWG. No. FM 6700
FORM: A4DRWGH